

Repairing passenger airbag

Removing and installing passenger airbag unit 07.96 ä

Important

1. Passenger's airbag unit

◆ Removing:

- In vehicles with encoded radio/radio-navigation system (RNS) Refer to code; if necessary, establish.
- Detach battery earthing strap/cable, cover over negative terminal.
- Open glove compartment.
- Unscrew glove compartment frame.
- Pull glove compartment frame backwards out of guides.

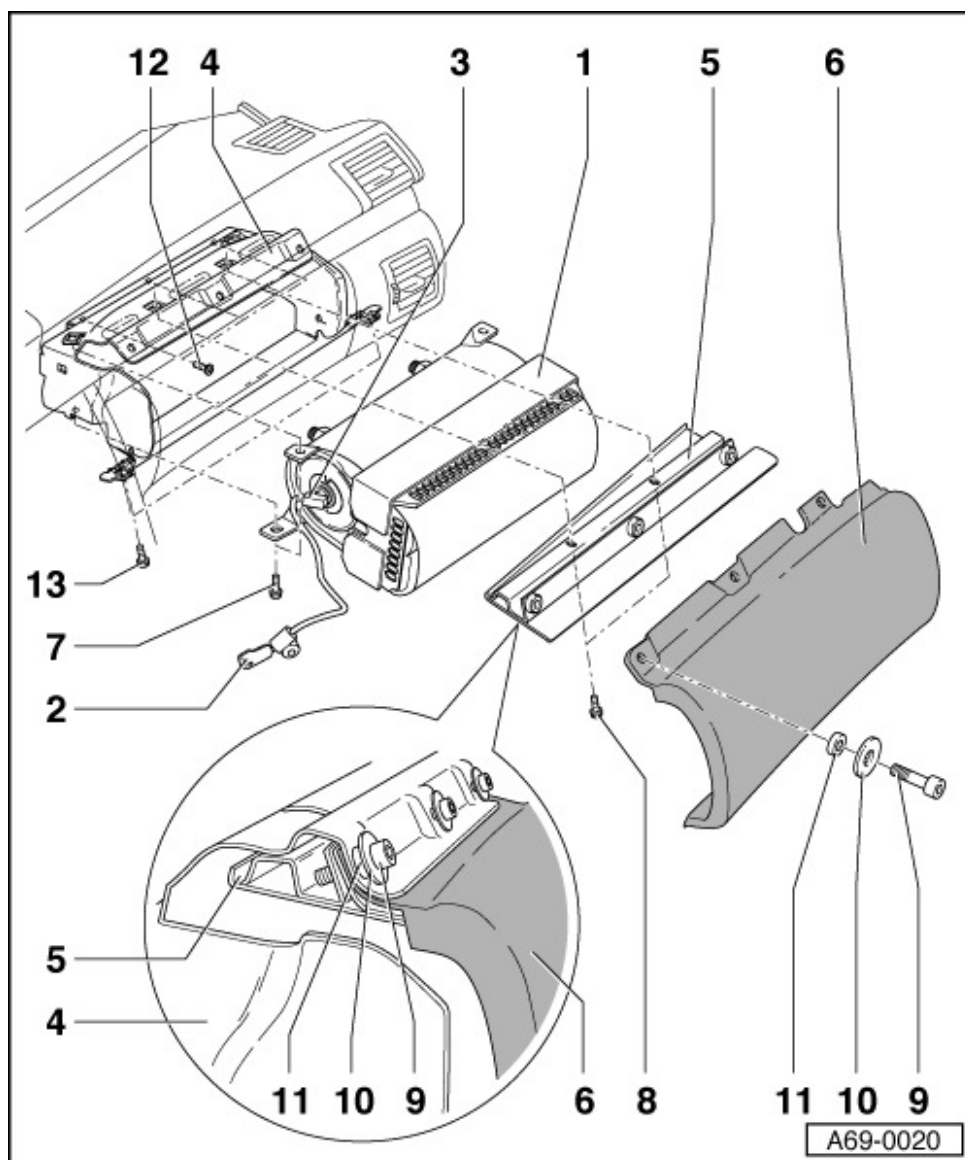

- Detach connector for glove compartment light; leave Bowden cable of lock connected.
- Lay aside glove compartment in passenger's footwell.
- Unscrew 4 bolts -Item 7- of airbag unit.
- Release and detach orange

- connector -
Item **2**-.
- Remove
airbag unit
downwards
and lay
down with
cushioned
side facing
upwards.
◆ Install in
reverse
order, note
the
following:
- Switch
ignition on.
- Connect
battery.

Important
*There must be no-
one in the vehicle
when the battery is
being connected.*

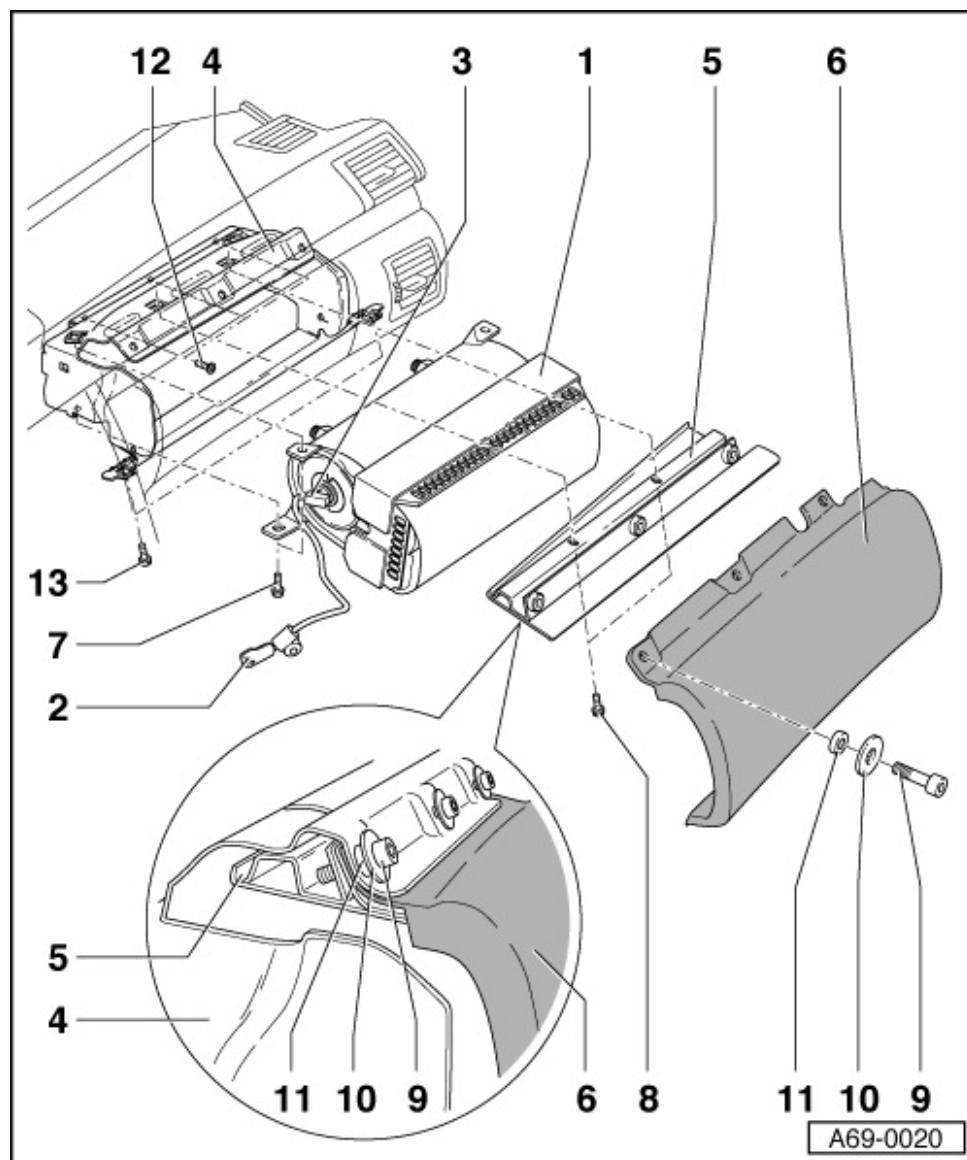

2. Orange connector

- ◆ Installation
position: Top
left in dash
panel
opening for
glove
compartment

3. Red connector

- ◆ Must not be
disconnected
from airbag
unit -Item **1**-.
◆ If connector
has been
detached
airbag unit is
defective
and must be
replaced

4. Retaining frame

- ◆ Replace
retaining
frame after
triggering of

passenger's
airbag

◆ Removing:

- Airbag unit -[1](#)-
- Screw out 3 bolts -Item [12](#)- and 2 bolts -Item [13](#)-.

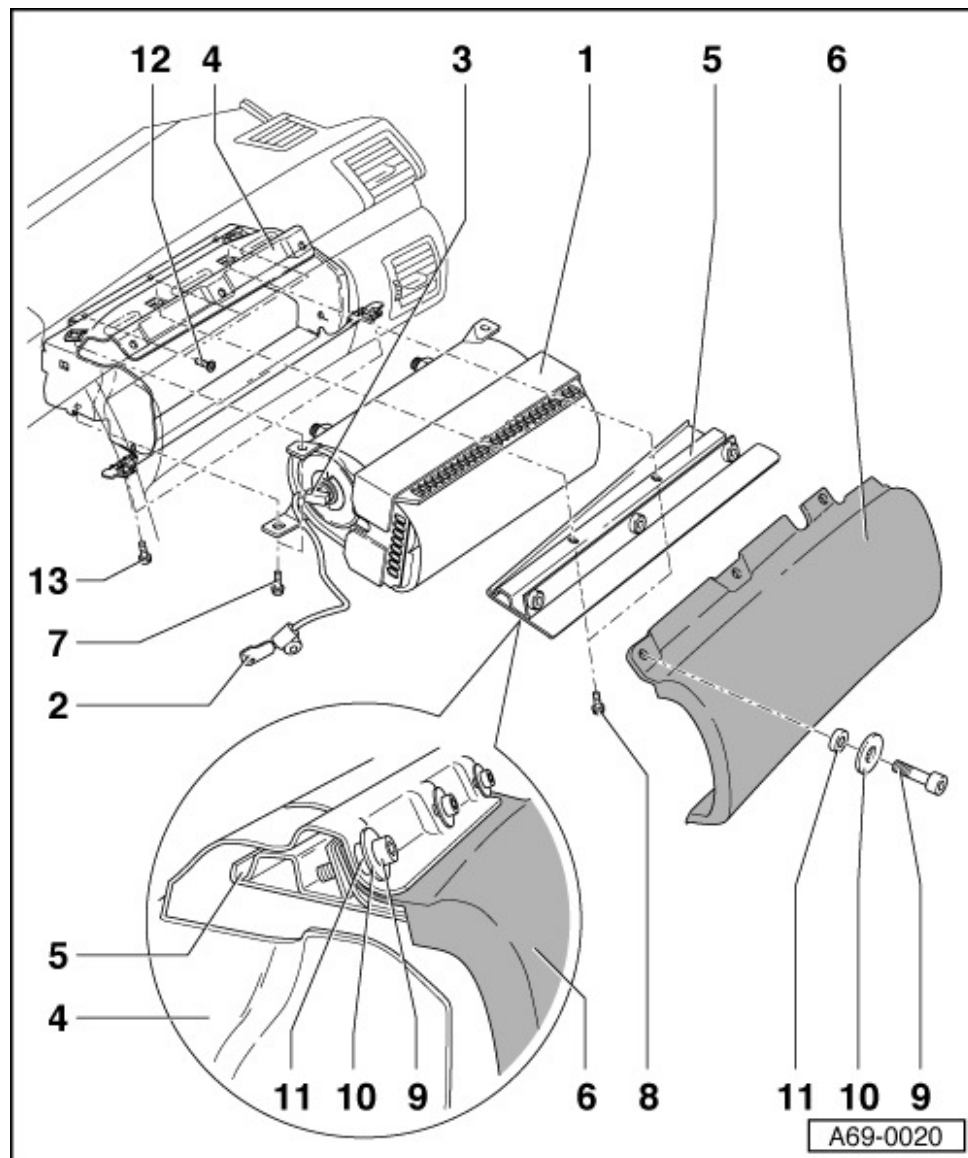

- Remove dash panel trim => Page [70-118](#).
- Screw out 3 bolts -Item [9](#)- and detach with washers -Item [10](#)- and spacer sleeves -Item [11](#)-.
- Take out retaining frame with retaining strip -Item [5](#)- and cap for airbag -Item [6](#)- downwards.
- ◆ Install in reverse

order

5. Retaining strip**6. Cap for airbag**

- ◆ Removing:
- Open glove compartment.
- Unscrew glove compartment frame.

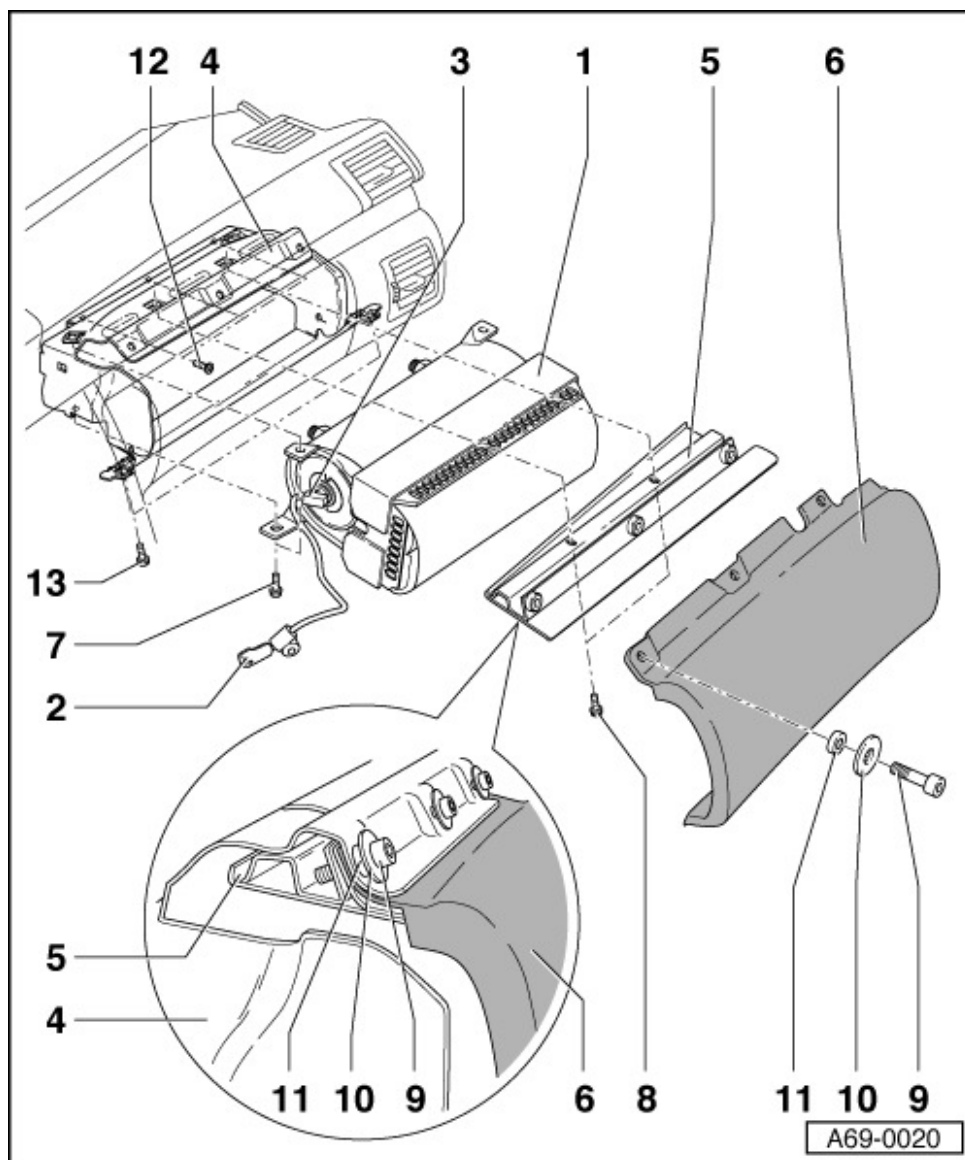

- Pull glove compartment frame backwards out of guides.
- Detach connector for glove compartment light; leave Bowden cable of lock connected.
- Lay aside glove compartment in passenger's footwell.
- Remove dash panel trim => Page [70-118](#).
- Screw out 3

bolts -Item [9](#)-
and detach
with
washers -
Item [10](#)-
and spacer
sleeves -
Item [11](#)-.

◆ Install in
reverse
order

- Slip slider
supplied
onto cap so
that it is
flush with
bottom.

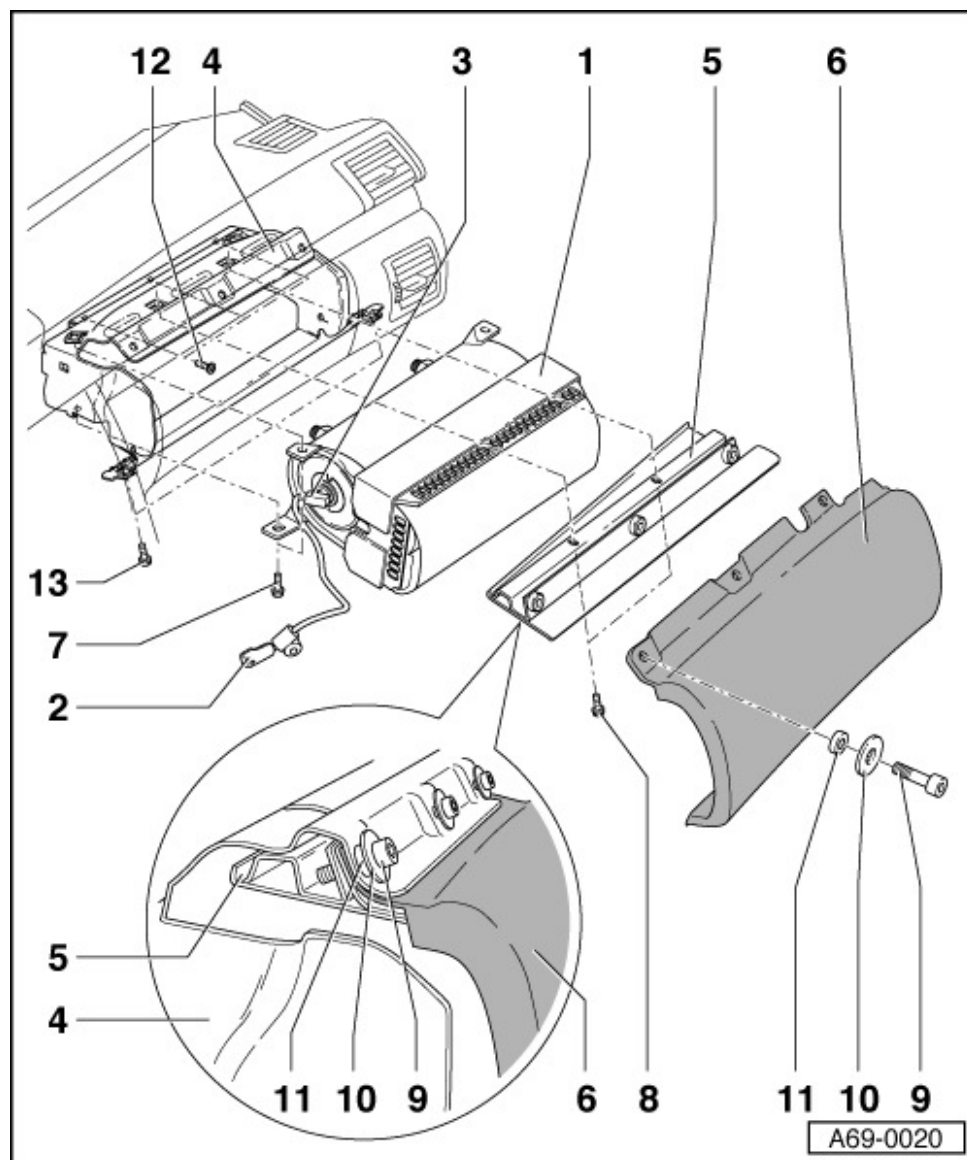

7. Bolt - 6 Nm

- ◆ 4 off
- ◆ Self-locking
- ◆ Replace
- ◆ Threaded bores for bolts must always be cleaned (e.g. with a thread tap)

8. Bolt - 3 Nm

- ◆ 2 off

9. Bolt - 3 Nm

- ◆ 3 off

10. Washer

- ◆ 3 off

11. Spacer sleeve

- ◆ 3 off

12. Bolt - 5 Nm

- ◆ 3 off

13. Bolt - 3 Nm

- ◆ 2 off

Notes:

- ◆ After connecting the battery, please ensure that the vehicle accessories (radio, clock, electric window lifters) are checked according to workshop manual and/or operating instructions.

=> Electrical System:
Repair group 27; Battery

- ◆ If the fault warning light (K 75) for airbag signals a fault after assembly the fault memory must be erased and again be interrogated by using fault reader V.A.G 1551.

=> Body Self-diagnosis:
Repair group 01

